

McKissick® European Style 45° Metric Sheaves

Selecting your Sheave O.D. / Wireline Size Combinations

To ease the effort in choosing the proper standard McKissick® Roll-Forged sheave required for your application, we have simplified our product offering. The table below indicates the standard Sheave O.D. / Wireline sizes that are available.

How to Read the Table

- Cells outlined in RED represent the standard O.D. / Wireline combinations available with the Sheave Configurator program.

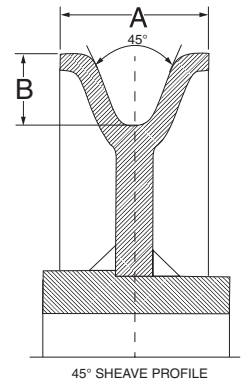

Sheave O.D. / Wireline Information

Wireline Size (mm)	Nominal Dimensions (mm)		Groove Radius (mm)		Sheave O.D. (mm)														
	A	B	MIN	MAX	280	300	320	350	400	450	500	520	550	600	630	650	700	800	
11	40	19	5.83	6.05															
12	40	18	6.36	6.60															
13	40	18	6.89	7.15															
11	40	19.5	5.38	6.05															
12	40	20.5	6.36	6.60															
13	40	19.5	6.89	7.15															
14	40	21	7.42	7.70															
15	40	21	7.95	8.25															
16	45	25	8.48	8.80															
17	45	25	9.01	9.35															
13	40	23	6.89	7.15															
14	40	22	7.42	7.70															
15	40	22	7.95	8.25															
15	45	25	7.95	8.25															
16	45	24	8.48	8.80															
17	45	24	9.01	9.35															
15	45	26	7.95	8.25															
16	45	25	8.48	8.80															
17	50	28	9.01	9.35															
18	50	27	9.54	9.90															
19	55	28.5	10.07	10.45															
20	55	25.5	10.60	11.00															
21	60	34	11.13	11.55															
22	60	33	11.66	12.10															
23	60	33	12.19	12.65															
19	55	31	10.07	10.45															
20	55	30	10.60	11.00															
21	55	30	11.13	11.55															
21	60	34	11.13	11.55															
22	60	33	11.66	12.10															
23	60	33	12.19	12.65															
21	60	34	11.13	11.55															
22	60	33	11.66	12.10															
23	60	33	12.19	12.65															
23	65	37	12.19	12.65															
24	65	36	12.72	13.20															
25	65	36	13.25	13.75															
26	70	39	13.78	14.30															
27	70	39	14.31	14.85															
23	65	37	12.19	12.65															
24	65	36	12.72	13.20															
25	65	36	13.25	13.75															
26	70	39	13.78	14.30															
27	75	43	14.31	14.85															
28	75	42	14.84	15.40															
29	75	42	15.37	15.95															
27	75	43	14.31	14.85															
28	75	43	14.84	15.40															
29	75	42	15.37	15.95															
28	80	47	14.84	15.40															
29	80	46	15.37	15.95															
30	80	45	15.90	16.50															
32	80	45	16.96	17.60															
30	90	50	15.90	16.50															
32	90	48	16.96	17.60															
34	90	48	18.02	18.70															
34	100	56	18.02	18.70															
36	100	54	19.08	19.80															
38	100	54	20.14	20.90															

McKissick Sheaves